

## **AMERICAN LEGION PREMIER ILLINOIS BOYS STATE**

Welcome to Eastern Illinois University. We hope you have an active, safe, and enjoyable week.

- All indoor activities take place in the Student Recreation Center (SRC) and the Lantz Building.  
The SRC is adjacent to Lantz Arena.
- No open toed shoes (sandals) are permitted in the rec center.
- All outdoor activities take place on the fields south of Lantz at the I-M Sports Pavilion.
- Enter the Lantz Building from the pond side (south) at ground level and continue to the north through the hallway to the SRC.
- Basketball, Volleyball, and Table Tennis are all played in the SRC.
- Tennis will be played on the Lantz courts southeast of the Field-house or in the Field-house in case of rain.
- Enter the Lantz pool from the locker room on ground floor.
- POST ACTIVITY SHOWER should be taken in the residence halls since no towels are provided at Lantz.

### **SPORTS EQUIPMENT ISSUE ROOM HOURS**

The equipment is issued at the SRC counter located in the SRC office area. Enter the Lantz Building on the ground level as you enter from the south side near the campus pond. The locker room is the first doors on the left before going down the hall to the SRC. Outdoor equipment is available at the Intramural Field Pavilion at the hours listed below.

Sunday..... 2:00 p.m. - 5:00 p.m. (Equipment at SRC Office)

Mon. - Thurs..... 3:30 p.m. - 6:00 p.m.

A Boys State identification card is required to check out all athletic equipment. Equipment must be returned on a daily basis.

---

### **RECREATIONAL SWIMMING HOURS- LANTZ SWIMMING POOL**

*Sunday - 2:30 – 4:30 pm*

*Monday-Thursday – 3:45 – 4:30 pm*

**SWIM TRUNKS ARE REQUIRED. NO CUTOFFS!!**  
**NO SHOES ARE ALLOWED IN THE POOL AREA!!**

# AMERICAN LEGION PREMIER ILLINOIS BOYS STATE SPORTS GENERAL RULES AND REGULATIONS

1. A roster must be completed, listing all players per team assigned. Only players listed on the team roster are eligible to participate in that team sport. An ineligible player will cause a forfeiture of the game.
2. Any player playing in more than one sport or with the wrong team/ county will be disqualified from all sports and the game in which he was ineligible to participate will be forfeited.
3. Officials have complete and final authority in the calls, including judgment calls.
4. Abusive language and unnecessary roughness to any official, staff member, coach, player or spectator will not be tolerated. Any player involved in such action will be suspended from all sports. If the occurrence is on the final day, the player will immediately be disqualified and requested to leave the area and report to the Director of Counselors.
5. Any team not present for play after ten (10) minutes of the assigned starting time will forfeit the contest.
6. Coaches must be present with their teams at the start of the game and remain for the entire contest. If it becomes absolutely necessary for the coach to leave, another counselor of that county must assume control.
7. Any team using illegal or ineligible player will forfeit the game, without discrimination.
8. Any dispute of any nature, or any protest by any coach, team or player, not otherwise covered by the assigned official for the contest, will be submitted to the Boys State Director of Athletics for final resolution.

## SINGLES TOURNAMENTS

Singles competition in table tennis and tennis will be held. Eligible players may only play in one tourney. **Enter all tourney "On-The-Spot" at 3:30 pm Thursday at the Campus Rec Sports Office in the Lobby of the SRC. Deadline is 4:00 pm for bracket preparation and matches will begin promptly at 4:15 pm.**

## ULTIMATE FRISBEE

During the Thursday afternoon recreation time, boys not playing in one of the sports championships can participate in Ultimate Frisbee in the Field-House. The designated counselor can retrieve the equipment from the SRC Office and the Rope for the Housing Office. Ultimate Frisbee will only be available if there is enough citizen interest.

## FITNESS CENTER AND FREE-WEIGHT AREA

A supervisor will be on site to provide instruction on use of aerobic equipment (Precor, Lifecycle, Liferower, Recumbent Bike, and True Treadmill).

# THE LANTZ BUILDING AND STUDENT RECREATION CENTER SPORTS FACILITIES

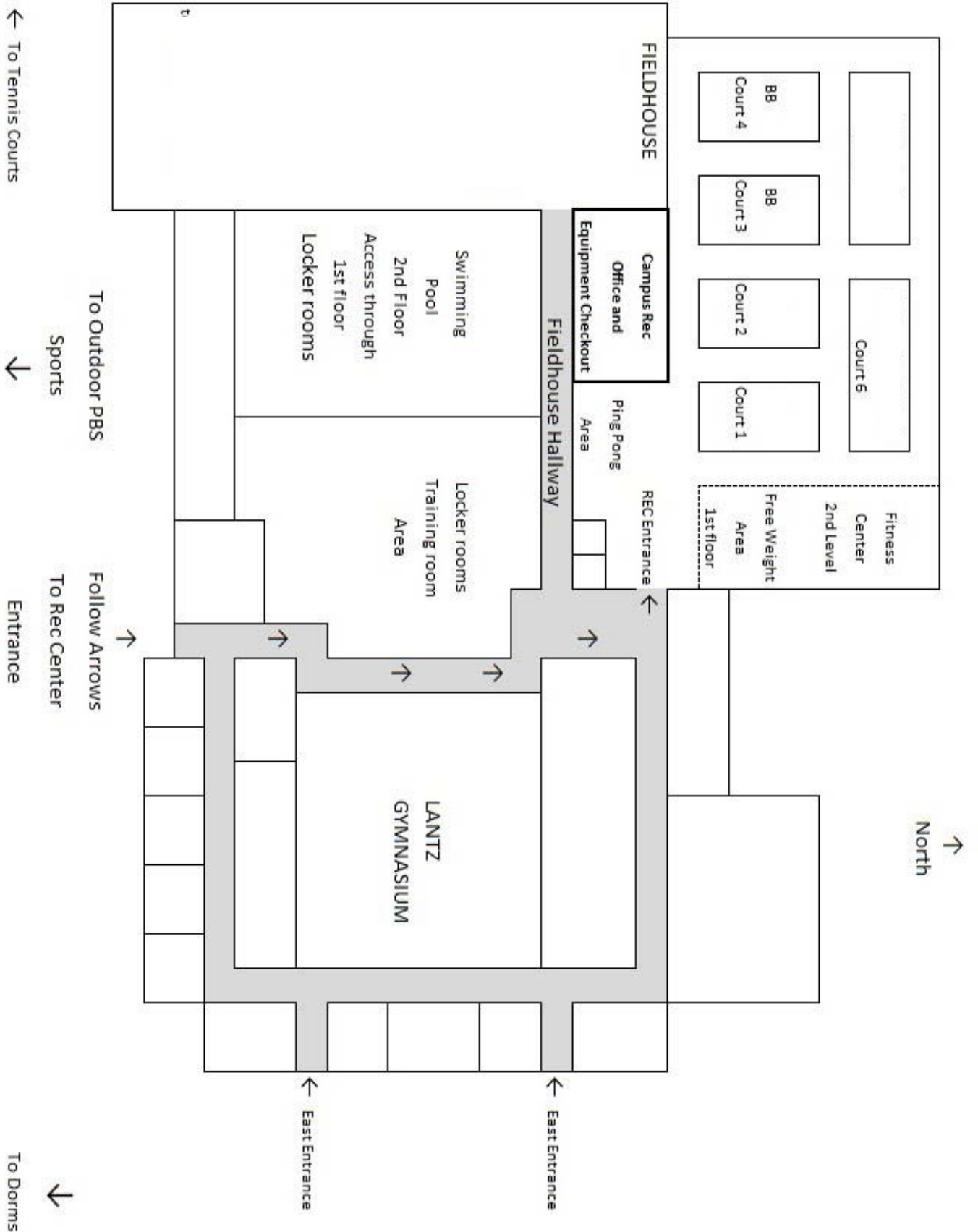

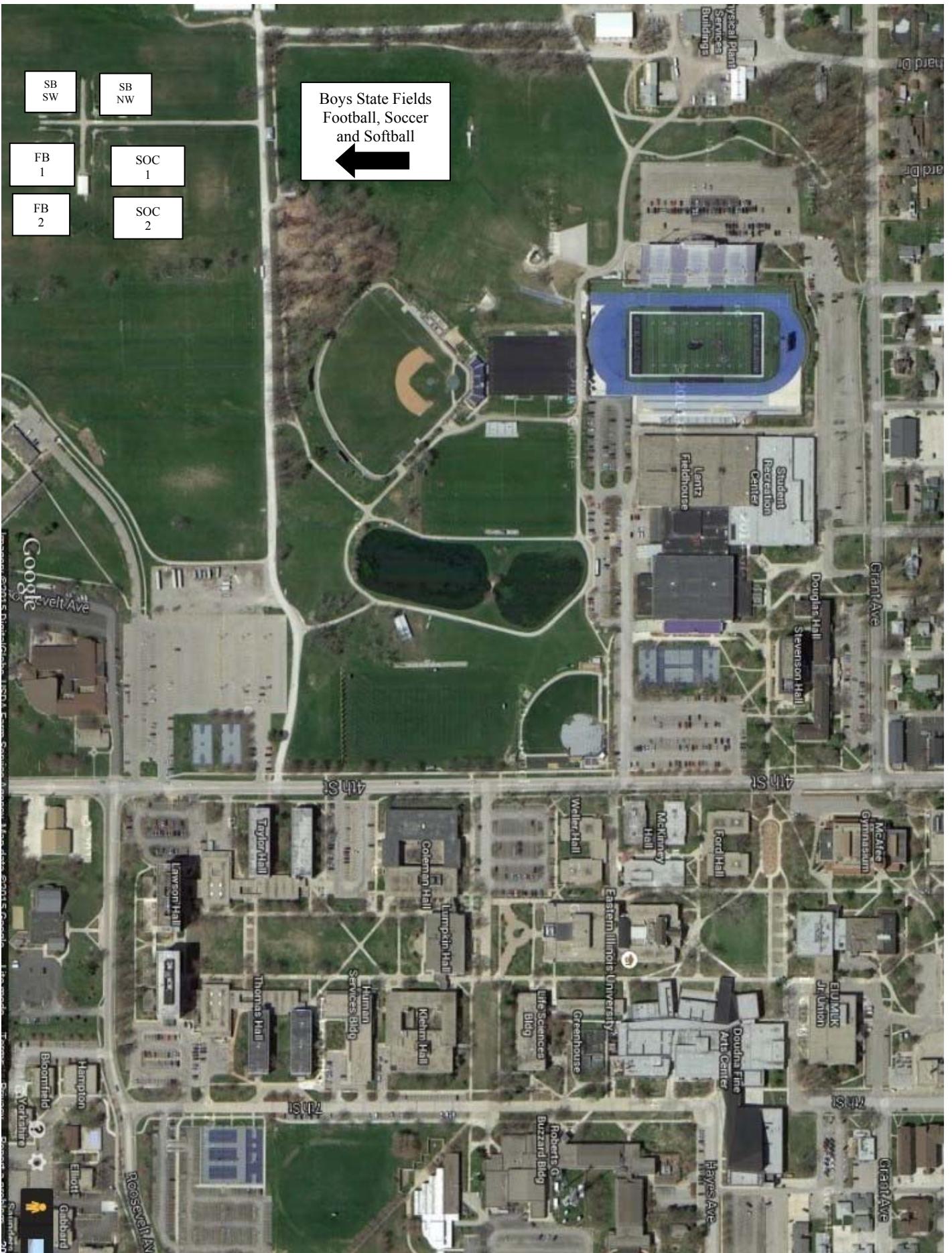

Boys State Fields  
Football, Soccer  
and Softball  
←

SB  
SW

SB  
NW

FB  
1

SOC  
1

FB  
2

SOC  
2